



Electrolux
PROFESSIONAL

Modular Cooking Range Line 700XP Half Module Gas Lava Stone Grill Top

ITEM # _____

MODEL # _____

NAME # _____

SIS # _____

AIA # _____



371044 (E7GRGDL00)

Half module gas lava stone
grill top

Short Form Specification

Item No. _____

To be installed on open base installations, bridging supports or cantilever systems. Suitable for natural gas or LPG. 7 kW stainless steel gas burners with flame failure device. Gas burners protected by stainless steel deflection trays preventing blockage from foreign objects. Cooking surface grids in cast iron, easily removable for cleaning. Exterior panels in stainless steel with Scotch Brite finish. One piece pressed work top in 1.5 mm thick stainless steel. Right-angled side edges to allow flush-fitting junction between units.

Main Features

- Unit to be mounted on open base cupboards, bridging supports or cantilever systems.
- Heating via Stainless steel gas burners with flame failure device.
- Burners protected by stainless steel deflection trays to prevent blockage.
- Piezo ignition.
- Cast iron grids can be adjusted on two levels.
- Stainless steel high splash guards on the rear and sides of cooking surface. Splash guards can be easily removed for cleaning and are dishwasher-safe.
- Scraper for cleaning of grilling grids included.
- Top configuration allows installation on ambient base only (not possible to install on refrigerated nor freezer base).
- Cooking grids made in highly resistant enameled cast iron for easy cleaning.
- Suitable for countertop installation.
- Lava stone included in standard delivery.

Construction

- All exterior panels in Stainless Steel with Scotch Brite finishing.
- One piece pressed 1.5 mm work top in Stainless steel.
- Model has right-angled side edges to allow flush fitting joints between units, eliminating gaps and possible dirt traps.
- IPX4 water resistance certification.

APPROVAL: _____



Experience the Excellence
www.electroluxprofessional.com

Included Accessories

- 1 of SCRAPER FOR FREESTANDING GRILLS PNC 206422

Optional Accessories

- | | | |
|--|------------|--------------------------|
| • Junction sealing kit | PNC 206086 | <input type="checkbox"/> |
| • Draught diverter | PNC 206126 | <input type="checkbox"/> |
| • Matching ring for flue condenser | PNC 206127 | <input type="checkbox"/> |
| • Support for bridge type system, 800mm | PNC 206137 | <input type="checkbox"/> |
| • Support for bridge type system, 1000mm | PNC 206138 | <input type="checkbox"/> |
| • Support for bridge type system, 1200mm | PNC 206139 | <input type="checkbox"/> |
| • Support for bridge type system, 1400mm | PNC 206140 | <input type="checkbox"/> |
| • Support for bridge type system, 1600mm | PNC 206141 | <input type="checkbox"/> |
| • Support for bridge type system, 400mm | PNC 206154 | <input type="checkbox"/> |
| • Chimney upstand, 400mm | PNC 206303 | <input type="checkbox"/> |
| • Right and left side handrails | PNC 206307 | <input type="checkbox"/> |
| • BACK HANDRAIL 800 MM - MARINE | PNC 206308 | <input type="checkbox"/> |
| • Flue condenser for 1/2 module, 120 mm diameter | PNC 206310 | <input type="checkbox"/> |
| • BASE SUPP. FOR FEET/WHEELS LATERAL 700 | PNC 206371 | <input type="checkbox"/> |
| • Chimney grid net, 400mm | PNC 206400 | <input type="checkbox"/> |
| • Stainless steel grid for free standing V-shaped grills (700XP) | PNC 206415 | <input type="checkbox"/> |
| • KIT HEIGHT ADJUST.SUPP.GRILL GRIDS | PNC 206418 | <input type="checkbox"/> |
| • Scraper for grids with drainage channels - top grills | PNC 206421 | <input type="checkbox"/> |
| • Frontal handrail 400mm | PNC 216046 | <input type="checkbox"/> |
| • Frontal handrail 800mm | PNC 216047 | <input type="checkbox"/> |
| • Frontal handrail 1200mm | PNC 216049 | <input type="checkbox"/> |
| • Frontal handrail 1600mm | PNC 216050 | <input type="checkbox"/> |
| • Large handrail - portioning shelf, 400mm | PNC 216185 | <input type="checkbox"/> |
| • Large handrail - portioning shelf, 800mm | PNC 216186 | <input type="checkbox"/> |
| • 2 side covering panels for top appliances | PNC 216277 | <input type="checkbox"/> |
| • Pressure regulator for gas units | PNC 927225 | <input type="checkbox"/> |

Front

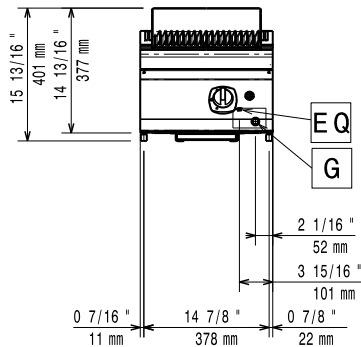

Side

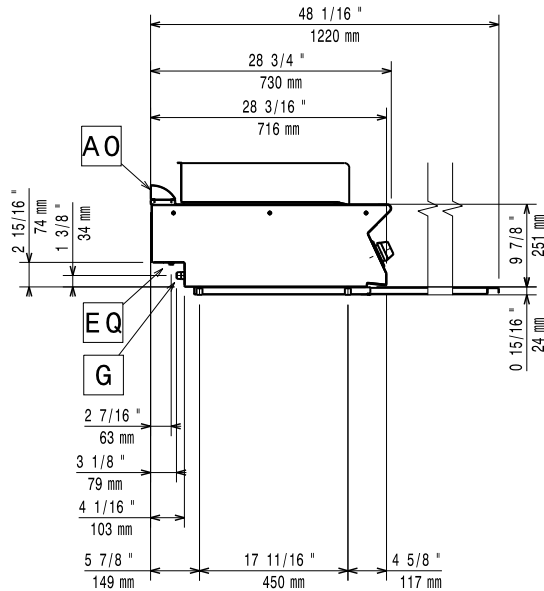

EQ = Equipotential screw
 G = Gas connection

Top

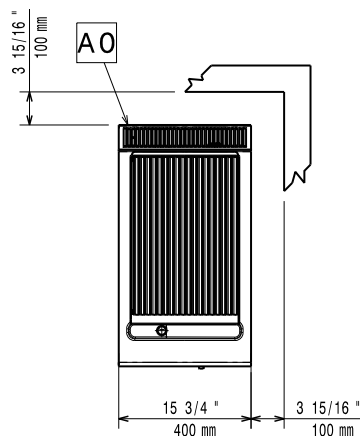

Gas

Gas Power:	7 kW
Standard gas delivery:	Natural Gas G20 (20mbar)
Gas Type Option:	LPG; Natural Gas; Town
Gas Inlet:	3/4"

Key Information:

If appliance is set up or next to or against temperature sensitive furniture or similar, a safety gap of approximately 150 mm should be maintained or some form of heat insulation fitted.

Net weight:	32 kg
Shipping weight:	46 kg
Shipping height:	530 mm
Shipping width:	460 mm
Shipping depth:	820 mm
Shipping volume:	0.2 m ³
Certification group:	N7GG
Cooking surface width:	321 mm
Cooking surface depth:	478 mm